

8FE+Reverse PoE XPON ONU FD-XPON8FE



1. Product Description

FULL DOMUS FD-XPON8FE is 8FE+Reverse PoE(Power Over Ethernet) XPON ONU. It is designed for meeting the multi-services needs of fixed network operators or cable operators, and widely used in FTTO (office), FTTD (desk), FTTH (home) broadband access, video surveillance and other requirements. It is based on mature GPON and Gigabit EPON technology, and has high ratio of performance to price, stable, cost-effective, high reliability, easy management, configuration flexibility and good quality of service (QoS) guarantees. It is fully compliant with GPON and EPON technical regulations such as ITU-T G.984.x, IEEE802.3ah and technical requirement of GPON/EPON Equipment from China Telecom. Dual mode ONU can automatically detect OLT and switch PON mode, it can be used as GPON or EPON.

The ONU is powered by the power sourcing equipment (PSE) deployed in users' residences, applied in scenarios where there is no alternating current (AC) power supply in corridors.

Features:

- ONU with reverse PoE(Power Over Ethernet)
- Dual mode ONU compatible with popular EPON and GPON OLT
- Outdoor Housing plastic or metal optional
- Support loop detection, IGMP, IGMP snooping
- 802.1Q VLAN, QinQ, Cos, DSCP, QoS for priority of service
- Support port speed, support for storm suppression
- Support Telnet, CLI, OMCI/OAM and Web management
- Firewall function
- Support remote software upgrade

2. Application Chart

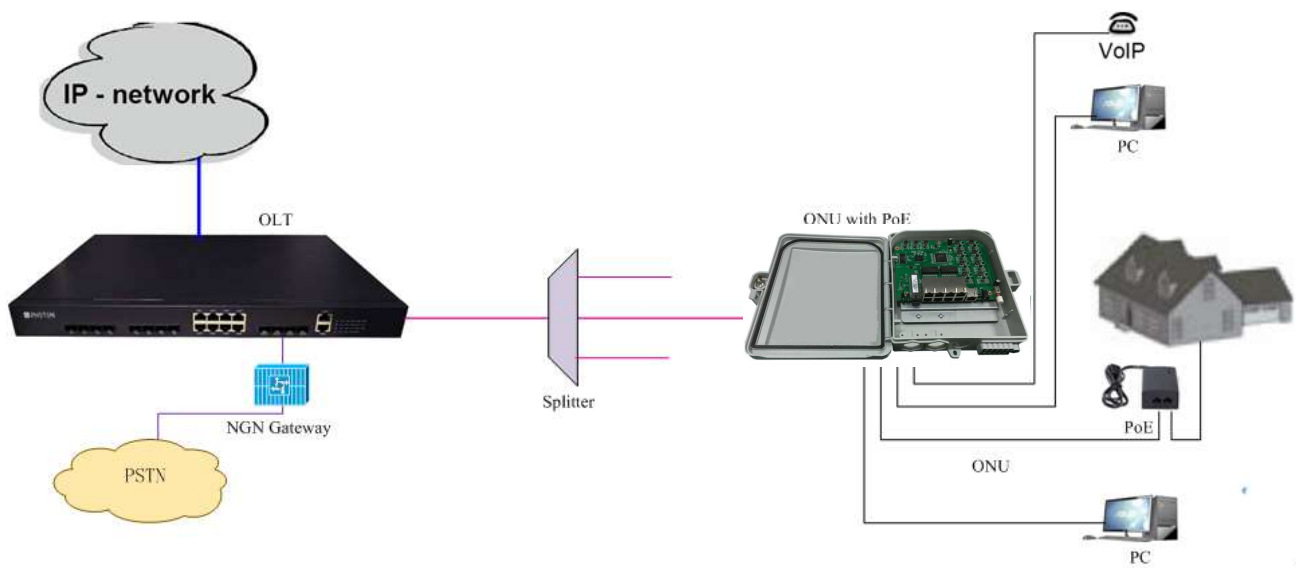

3. Technical parameters

Items	Unit	Specifications
PON standard.		EPON IEEE802.3ah, GPON ITU-T G.984.x
Optical interface		SC/PC connector, 1 GPON/EPON interface (EPON PX20+ and GPON Class B+) Receiving sensitivity: $\leq -28\text{dBm}$ Transmitting optical power: $0\text{dBm} \sim +4\text{dBm}$ Transmission distance: 20KM
Speed	Gbps	GPON: uplink 1.25Gbps, downlink 2.5Gbps; EPON: symmetric 1.25Gbps
Wavelength	nm	Tx1310, Rx 1490
Interface	data	8FE 10/100Mbps Auto adaptive Ethernet interfaces, Full/Half Duplex, RJ45 connectors
Indicator	LED	POWER 、 LOS 、 PON 、 LAN 、 SYS 、 PoE
Operating condition	°C	Operating temp: $-5 \sim +55$
Storing condition	°C	Storing temp: $-30 \sim +60$
Humidity	%	10~90(non-condensing)
Power supply	V	DC 12V/1A or Powered by the power sourcing equipment (PSE)
Power consumption	W	≤ 8
Dimension	mm	Plastic: 280mm×250mm×100mm (L×W×H) Metal: 210mm×145mm×43.6mm (L×W×H)
Net weight Kg		Plastic: 0.8Kg Metal: 1.4Kg