

Mechanical Fiber Optic Connector-Fiber Pre-embedded Tech

SC/UPC



SC/APC



Description

Mechanical connectors make fiber terminations quick, easy and reliable. These fiber optic connectors offer terminations without any hassles and require no epoxy, no polishing, no splicing, no heating and can achieve similar excellent transmission parameters as standard polishing and splicing technology. Our connector can greatly reduce the assembly and set up time. The pre-polished connectors are mainly applied to FTTH cable in FTTH projects, directly in the end user site.

Features

- ✧ Low insertion loss
- ✧ Ease of installation
- ✧ Low cost & Reliability
- ✧ Ease of use
- ✧ Low environmental sensitivity
- ✧ High return loss (low amounts of reflection at the interface)

Specification

	Singemode(UPC)	Singemode(APC)	Multimode
Insertion loss	$\leq 0.2\text{db}$	$\leq 0.2\text{db}$	$\leq 0.25\text{db}$
Return loss	$\geq 45\text{db}$	$\geq 55\text{db}$	$\geq 30\text{db}$
Durability	$\leq 0.2\text{db}$ typical change, 1000 times mating		
Operating Temperature	-45 to +85 degree		
Ferrule Hole Sizes	125.0+1/-0um, Concertricity: $\leq 1.0\text{um}$	125.0+1/-0um, Concertricity: $\leq 0.5\text{um}$	127.0um, Concertricity: $\leq 3.0\text{um}$
	125.5+1/-0um, Concertricity: $\leq 1.0\text{um}$	125.5+1/-0um, Concertricity: $\leq 0.5\text{um}$	
	126.0+1/-0um, Concertricity: $\leq 1.0\text{um}$	126.0+1/-0um, Concertricity: $\leq 0.5\text{um}$	

Product in detail:



Operating Process:



1. Fast connector assembly

2. Put the cable into the boot.

3. Strip the cable

4. Fiber length: 50mm~60mm



5. Strip the fiber cladding, 24mm from the cable

6. Clean the fiber with alcohol

7. Cut the fiber with tools

8. Move the buckle to the end, insert the fiber, and micro-bend the fiber.



9. Keeping the fiber micro-bent, and move up the buckle to block the fiber

10. Block the boot.

11. Put on the shell, PC is blue, and APC is green

12. Repeated assembly: move down the buckle to release the fiber, move the boot.

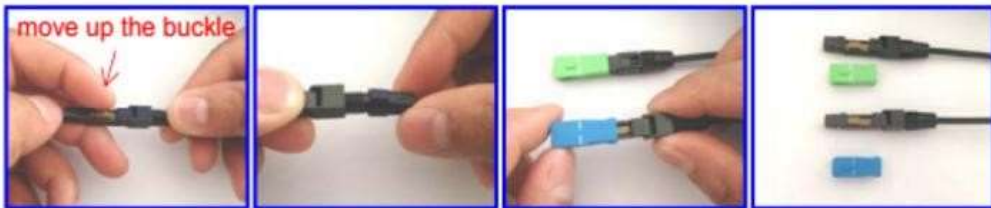

9. Keeping the fiber micro-bent, and move up the buckle to block the fiber

10. Block the boot.

11. Put on the shell, PC is blue, and APC is green

12. Repeated assembly: move down the buckle to release the fiber, move the boot.

Package & delivery

The package will be packed according to standard export requirements, customer satisfaction is our target.

Label printing : Customer logo or customized package are available

Inner packing: 10pcs in a blister box

Outer packing: the carton will be packed with sack, well protect carton from dust and wet.



Applications

- ✧ CATV & FTTH
- ✧ Telecommunication networks
- ✧ Local area networks (LAN)
- ✧ Wide area networks (WAN)
- ✧ Premise installations
- ✧ Data processing networks
- ✧ Video and military active device termination
- ✧ Optical Distribution Frame
- ✧ Optical Network Equipments